

# Pack PI

---



Rectangular steel litter bin, consisting of a structure with rain cover in galvanized and polyester powder-coated steel sheet and two panels, one fixed at the rear, the other at the front that can be opened as a door equipped with a snap lock with triangular key, both in galvanized sheet metal and polyester powder coated. The litter bin is equipped with a sliding bag holder ring.

---

**Variant code:** 0025624

---

**Size and weight:** Width 280mm  
Length 410mm  
Height 910mm  
Weight 46kg  
Capacity 50lt

---

**Materials:** Structure: Steel treated with protective coating and powder coating

Door: Steel treated with protective coating and powder coating

Back panel: Steel treated with protective coating and powder coating

Bag holder ring: Steel treated with protective coating

---

**Finishes:** Polyester powder coated steel in wrinkled finish

Color:  
to be chosen from Metalco standard colour range

---

**Fixing:** Ground fixing with threaded bars

---

**Accessories:** Kit piedini da appoggio

---

Technical drawing:

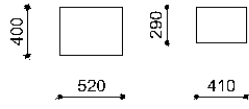
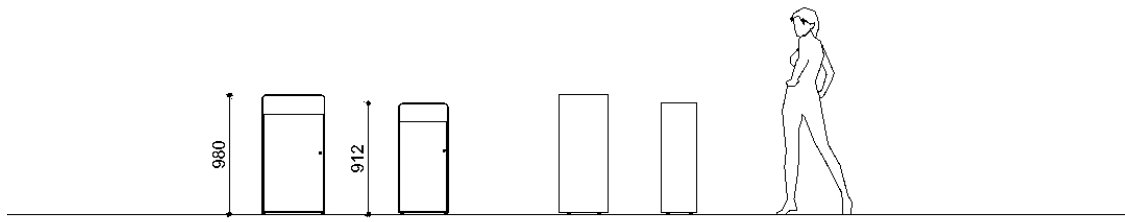

Ground fixings

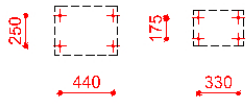

metalco.it  
info@metalco.it



# POWDER COATED STEEL - POWDER COATED ALUMINUM

For every steel product and component, we choose the most suitable raw materials and treatments based on our production cycle and the needs of each design.

Our steel treatments include hot-dip galvanization, cold galvanizing, Sendzimir galvanization, cataphoresis and primer coating.

For our aluminum products and components, we use aluminum in sheet or in extrusion or in casting.

Then we powder coat steel, stainless steel, and aluminum with polyester powder, in accordance with EN ISO 12944-2.

We offer a wide range of standard RAL colors with wrinkled finish with different levels of texture. Only when customization through stickers, pad printing or serigraphy is provided, for technical reasons, their finish will be smooth matte or smooth glossy, depending on the technical feasibility.

We also offer the exclusive SABLÈ' colours, with a peculiar metallic wrinkled texture.

Upon request, different treatments and customizations are available, such as powder coating with non-standard RAL colors, and/or with smooth matte and smooth glossy finishes, and/or anti-graffiti treatment.

If required, the powder coating process can be certified Quality Steel.

## RAL



## SABLÈ



The mentioned RAL and SABLÈ colours should be considered only illustrative.

metalco.it  
info@metalco.it

